

SUMITOMO RIKO GROUP

SumiRiko Italy S.p.A.

SumiRiko LEVII / LEV III with OBD Stoneridge Valve

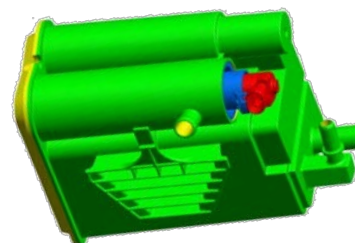

Construction and material:

Housing/ Material	2 chambers / material (PA66)
Charcoal Type	1.5lt BWC 11 Pellet + 2HCA
Felts	n° 2 (welded)
Dip pipe	Yes
Retention Charcoal system	Springs, grids and felts
OBD System	Stoneridge valve + foam filter

Canister characteristics:

NWC [grams]	> 77 gr
Pressure Drop [Adsorption]	< 15 mbar @ 70 Slit/min.
Pressure Drop [Desorption]	< 30 mbar @ 70 Slit/min.
Emission requirements	CARB LEV II - Poor purge

Standard and :

Product	Minimum batch	N/A	Minimum lengths	N/A	Preformed	N/A
International standard	CARB LEV II - EPA ORVR					
Standard - Customers	Daimler A 001 001 08 99					